

Why DOGPAW?

Neither Clark County nor its Cities can pay for development of off-leash areas without help. Through DOGPAW, dog owners ensure development of spaces for their use.

As a non-profit organization, DOGPAW can partner with Vancouver-Clark Parks and Recreation, Washougal Parks and Recreation, Clark County Public Works and others, like Bonneville Power Administration, to secure and develop land for off-leash areas.

Why Are Dog Parks Important?

Bored, inactive dogs find ways to get into trouble. Well exercised dogs make better neighbors when they are able to get out and run and play regularly and burn off some of their energy. The parks are social outlets for dogs and their humans as well, and help us all connect and have a little badly needed play time!



In the long run, off-leash dog parks make a community safer, stronger and more pet friendly, and help people keep their pets happier and healthier; and sometimes even means they can keep them when otherwise they might be given up due to boredom related destructive behavior at home.

Come join us, and bring a friend!

Did You Know?

All Clark County official off-leash areas are completely built, managed, and maintained by supporters of DOGPAW (members, donors, volunteers, and partners) with dedicated volunteers and donations.

Please visit us online for more details.

www.clarkDOGPAW.org

Revised 04.26.11 v1

Off-Leash Dog Areas

All of our parks are fenced and gated with various features. Wherever you travel, always be prepared with your own supplies, like plenty of water and waste bags.

Brush Prairie (SR-503) NE 149th St & NE 101st Pl

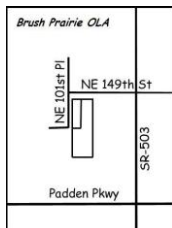

Dakota (East Vancouver) NE 18th St & NE 164th Ave



Hockinson (Temporary Spot) NE 172nd Ave & NE 119th St

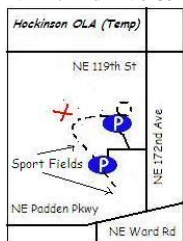

Ross (West Vancouver) NE Ross St & NE 15th Ave

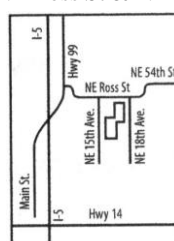

Stevenson (Washougal) 32nd St & Addy St

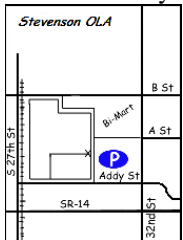

We plan to build approx 6-8 total off-leash areas throughout Clark County to serve its residents. Please join us to help reach that goal!

Visit us online for more details...

www.clarkDOGPAW.org



Dog Owners Group for
Park Access in Washington

Our Mission:

To work with dog owners and the larger community to promote awareness and acceptance, and to increase the availability of safe off-leash areas for dogs in Clark County.

DOGPAW is an **all-volunteer non-profit** organization registered in the State of Washington
THANK YOU!

DOGPAW (501c3)
13504 NE 84th St Ste 103 Pmb 303
Vancouver WA 98682-3091
Phone/Fax: 888-899-0025

www.clarkDOGPAW.org

Mail completed form with check or join  online!

DOGPAW (501c3)
13504 NE 84TH ST STE 103 PMB 303
VANCOUVER, WA 98682-3091
www.clarkdogpaw.org/dogpawstore/

Name(s): _____

Street/Mail Address: _____

Phone | Email: _____

Dog Breed & Name: _____

Notification: e-mail *or* postal

Subscription:

NONE *or* monthly e-news

NO JUNK MAIL
Just DOGPAW info

***YEARLY MEMBERSHIP:** New Renewal
___ Quantity: single \$15 ___ Quantity: family \$25
(qualifies for single - one vote and family – two votes)

Additional donation: _____

COMMITTEE INVOLVEMENT

NONE *or* PLEASE INVITE ME, I am best suited to:
___ Finance. ___ Development. ___ Membership. ___ Safety. ___ Adhoc.

Optional NEW (not renewal) – CLARK COUNTY ANIMAL PROTECTION & CNTRL DOG/CAT LICENSE:

Rabies (Expires | Veterinarian): _____

Owner Resident of: Unincorporated Clark County
 City of Vancouver Town of Yacolt
(City Limits of Battle Ground/Camas/Washougal -- Contact Them)

Pet: _____
(Name | Breed | Color | Sex (F, FS, M, MN))

- Dog: Fertile \$40, Altered \$16 -- Cat: Fertile \$20, Altered \$10.
- Senior discount: 50% for one altered dog and cat per household.
- Service Animal and/or Juvenile (8 wk to 6 mo) – free license required.
~ Add Agent Fee of \$2.00 per License ~

*As a member of DOGPAW, I agree to abide by the rules posted in Clark County’s official off-leash areas.

Membership and Donations!

Become a member of DOGPAW and help mold and shape *your* off-leash dog parks! Membership is open to any resident of Clark County or neighboring communities.



Your tax-deductible donations, both membership fees and those above & beyond, go into off-leash! Donations support all maintenance of existing parks and development of new parks, including waste management, mowing, and purchase and installation of building materials and fences. Please consider a donation today, and we’ll provide you with a receipt for tax purposes!

Keep Informed

Join the DOGPAW e-news dogpaw prints newsletter online at www.clarkdogpaw.org and we will keep you informed of latest news and upcoming events!

A CAUTION about Dogs and CHILDREN



A screaming, running or unattended child may become a natural target for dogs. Even a playful dog can knock over or inadvertently run over a child and cause serious physical or emotional trauma.

✦ ICE: In Case of an Emergency ✦

- Call **911** IMMEDIATE police-fire-ambulance.
- ASPCA **Animal Poison** Control 888-426-4435.
- **Animal Control:**
Clark County 360-397-2488

La Center 360-263-2745	Battle Ground 360-342-5100
Ridgefield 360-887-3556	Camas 360-335-0432
Yacolt 360-686-3922	Washougal 360-835-8701

- **Humane Society:**
Vancouver 360-693-4746 or Washougal 360-835-3464.
- Take a **picture** with your camera phone.
- **ID** dog, handler, license plate, and witnesses.
- **Report** incident to muttley@clarkdogpaw.org.



Politely, safely, help each other and inform DOGPAW.
13504 NE 84th St #103 Pmb 303 Vanc WA 98682 888-899-0025

⌘ keep ICE & your veterinarian info in wallet ⌘



Official Off-Leash  Dog Park Rules:

BY ENTERING THIS PARK YOU AGREE TO ABIDE BY THE POSTED RULES. THIS PARK IS FOR DOGS AND THEIR HANDLERS. ALL CHILDREN MUST BE ACCOMPANIED BY AN ADULT AND SHOULD NOT BE ALLOWED TO PLAY UNATTENDED. ALL USERS OF THIS PARK DO SO AT THEIR OWN RISK AND ARE RESPONSIBLE FOR ANY PROBLEMS CAUSED BY THEIR DOG.

1. Dogs under 4 months of age, female dogs in heat, unaltered male dogs over 1 year of age, and sick dogs are NOT allowed.
2. Your dog MUST be licensed, vaccinated, and wear an appropriate collar with tags. Pinch collars, prong, choke, spike, etc, are NOT allowed.
3. Dogs MUST be removed from the park at the first sign of aggression.
4. Handlers MUST promptly respond to any request to “call or control your dog”.
5. Do NOT allow your dog to jump on people or bark excessively.
6. Handlers MUST immediately clean up by picking up waste and filling any holes created by their dog.
7. Under NO circumstances are you allowed to leave your dog or child unsupervised in the park.
8. Handlers MUST leash and unleash their dog within the double-gated entrance and carry a leash for each dog.
9. Food, smoking, and glass containers are PROHIBITED.

City & County Code

Fines up to \$250